

ITEM NO.	PART NUMBER	DESCRIPTION	DRAWING #	QTY.
1	BO-5/8x1-3/4 FLHCS	BOLT 5/8 x 1-3/4" FLANGED	STOCK	6
2	BO-5/8 HNN	LOCK NUT 5/8	STOCK	6
3	CLL4-2 C DRIVER SIDE	DRIVER SIDE CENTER BRK CLL-4	90-1804-24	1
4	CLL4-2 PASSENGER C SIDE	PASSENGER SIDE CENTER BKT CLL-4	90-1804-24	1
5	CLL4-3 DRIVER SIDE	REAR BRKT DRIVER SIDE CLL-4	90-1804-28	1
6	CLL4-3 PASSENGER C SIDE	CLL4-3 PASSENGER	90-1804-28	1
7	FI .25 X 3 L 2.25	LENGTH: 2-1/4"	STOCK	4
8	FI 1x1.25 L 3.25	LENGTH: 3-1/4"	STOCK	2
9	FP-CLL4-TUBE	FRONT SUPPORT, CLL-4, CLL-6	90-1804-21	1
10	FP-CLL2-7	LEVEL LOCK, FRONT REINFORCING PLATE	90-2805	4

REVISIONS			
REV.	DESCRIPTION	DATE	APPROVED
A	REV. TO NEW STANDARD PRINT FROM 10-1816	1/21/2013	
B	ADDED SOLENOID VALVE NOTES	4/29/2013	

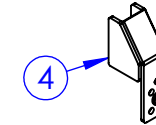

**1999-2010 CHEVY/GMC
40" or 56" CAB TO AXLE
SINGLE/DUAL WHEEL**

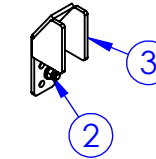
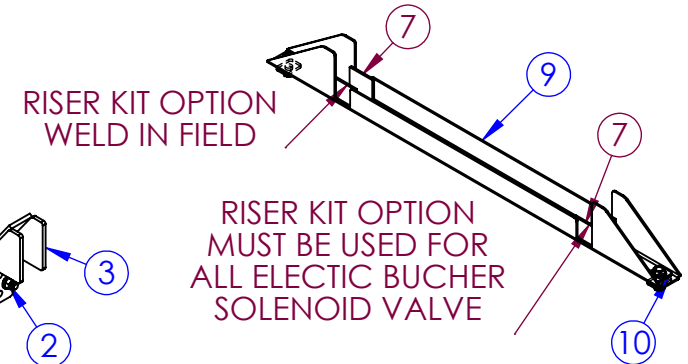
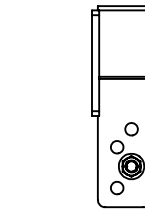
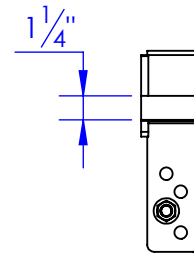
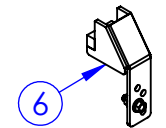
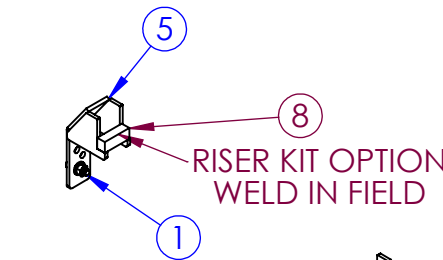
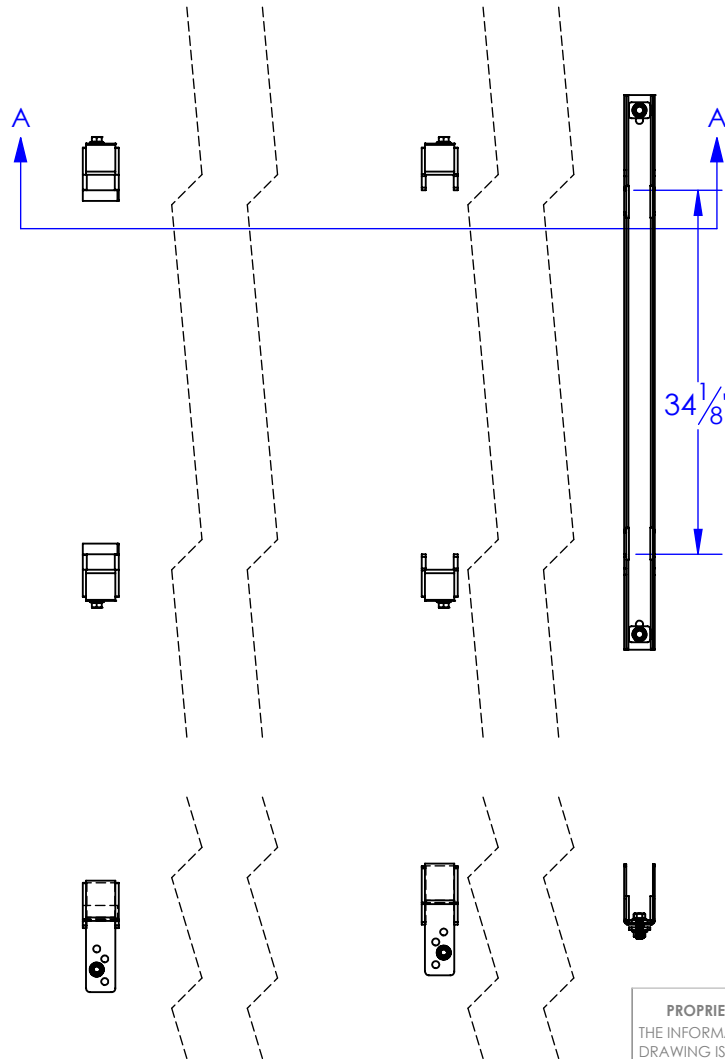

SECTION A-A
SCALE 1 : 10

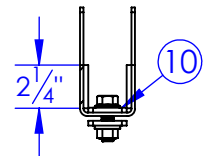

PROPRIETARY AND CONFIDENTIAL
THE INFORMATION CONTAINED IN THIS
DRAWING IS THE SOLE PROPERTY OF TRIPLE
C INC. ANY REPRODUCTION IN PART OR
AS A WHOLE WITHOUT THE WRITTEN
PERMISSION OF TRIPLE C INC. IS PROHIBITED.

DIMENSIONS ARE IN INCHES TOLERANCES: FRACTIONAL $\pm 1/16$ ANGULAR: MACH ± 1 BEND \pm TWO PLACE DECIMAL ± 010 THREE PLACE DECIMAL ± 005	
MATERIAL	--
DO NOT SCALE DRAWING	

NAME	DATE
DRAWN HEATH	4/29/2013
PART # LL-CLL-4	
ASM #	
COMMENTS: 1999-2010 CHEVY/GMC 40" or 56" C/A LEVEL LOCK TYPE 4	

P.O. BOX 248, SABETHA, KS 66534	
TRIPLE C INC	
SIZE A	DWG. NO. 90-1804 B
SCALE: 1:18	WEIGHT: 51.47
SHEET 1 OF 1	

GENERAL INSTRUCTIONS AND CAUTIONS

Note: When welding, attach welder ground only to Hydra-Bed, not to truck frame. Use low-hydrogen rod or wire electrode. NEVER weld to the frame of the truck. Correct installation of the Level-Lok system assures Front to Rear and Side to Side leveling as well as Left to Right centering of the Hydra-Bed. Never obstruct factory overload spring mounting locations.

When drilling truck frame, do not damage any part of the braking, fuel or electrical systems.

VIEW OF REAR LEVEL-LOKS ON TRUCK FRAME

Hydra-Bed Frame Width

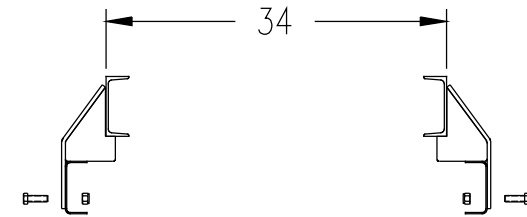

Bolt 2 1/2x2 1/2x54" tube to factory frame risers. Center Hydra-Bed 10" from each end of tube. Weld Hydra-Bed frame to tube risers. Hydra-Bed frame will be resting on tube and between risers.

Locate center CLL-4 on straight frame section. Drill 11/16 dia hole in frame. Bolt CLL-4 center in place.

Locate rear CLL-4 over 1/2" pilot hole approx 1 1/4" from rear of frame. Drill hole to 11/16". Bolt CLL-4 in place.

